

C4-Verdichter:
4VC(S)-6.2(Y) .. 4NC(S)-20.2(Y)
4C1480SL .. 4C2397PH

C4 Compressors:
4VC(S)-6.2(Y) .. 4NC(S)-20.2(Y)
4C1480SL .. 4C2397PH

Compresseurs C4:
4VC(S)-6.2(Y) .. 4NC(S)-20.2(Y)
4C1480SL .. 4C2397PH

Neue Einbau-Position
für die Ölsumpfheizung
ab Januar 2006

New mounting position
for crankcase heater
from January 2006 on

Nouvelle position de montage
pour la résistance de carter
à partir de janvier 2006

Neu
New
Nouveau

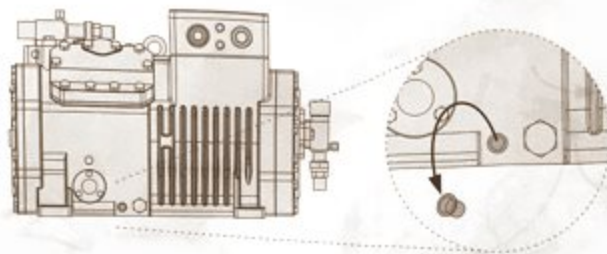

bis Dezember 2005
until December 2005
jusqu'à décembre 2005

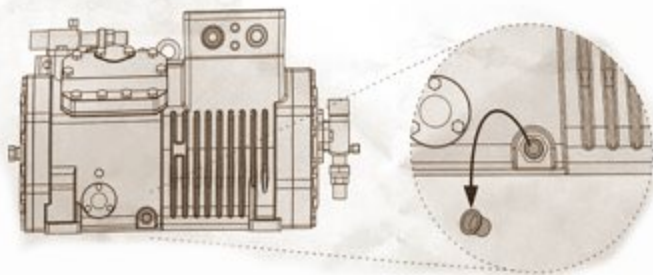

2EC-2.2(Y) .. 4NC(S)-20.2(Y): 2EC-2.2(Y) .. 4NC(S)-20.2(Y): 2EC-2.2(Y) .. 4NC(S)-20.2(Y):
 Ölsumpheizung einbauen Mounting the crankcase heater Monter la résistance de carter

1

2EC-2.2(Y) .. 4CC-9.2(Y)

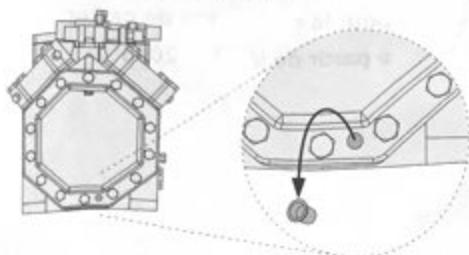

4VC(S)-6.2(Y) .. 4NC(S)-20.2(Y)

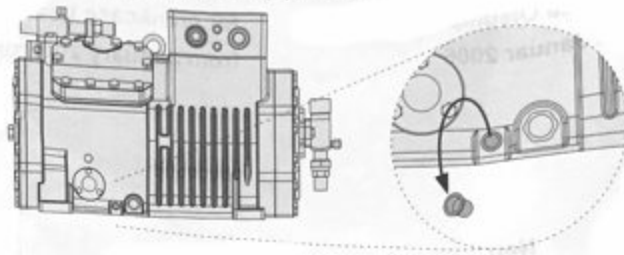

2

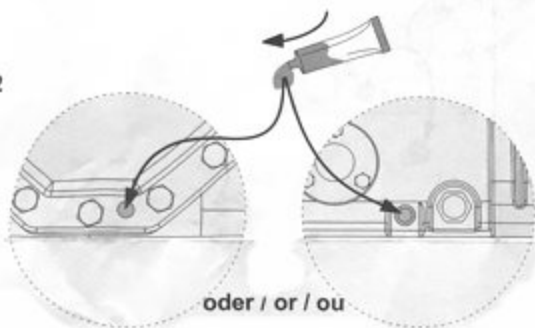

oder / or / ou

3

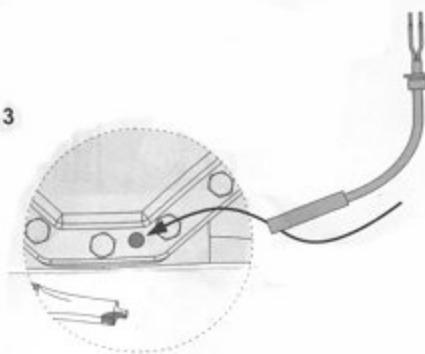

4

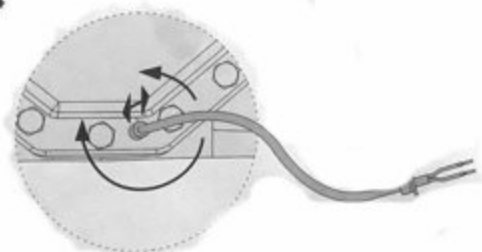

5

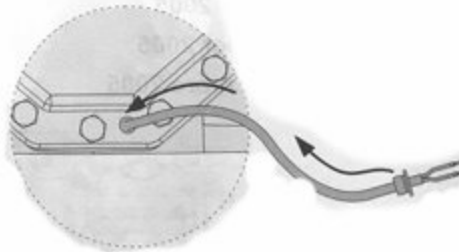

6

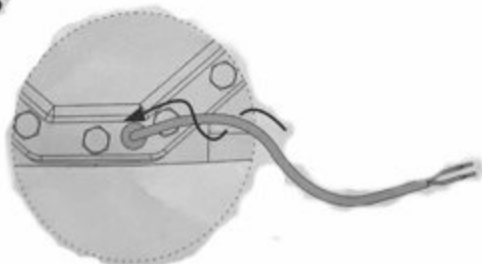

7

